

HARDWARE LIST

I Shelf Support 8 Pcs	II Minifix Cam 12 Sets	III Minifix Pin 12 Pcs	IV Screw M6.3x50mm 1 Pc	V Allen Key M4 4 Pcs	VI JCBC M6x50mm 4 Pcs	VII Adjust Screw 4 Pcs	VIII Metal Leg 484mm 4 Pcs	IX Metal Leg 1440mm 2 Pcs	X M8x20mm Rattan Screw 4 Pcs	XI M8x38mm Rattan Screw 14 Pcs	XII Hinges 7/8 4 Sets	XIII 3.5x16mm Screw 34 Pcs	XIV Nail 36 Pcs	XV Seal Sticker 4 Pcs	XVI Handle 3 Pcs	XVII Drawer Slide 14" 6 Pcs	XVIII 3.5x12mm Screw 1 Set	XIX 4x38mm Leg 150mm 8 Pcs	XX 4x38mm Screw 1 Pc	4 Pcs
--------------------------------	---------------------------------	---------------------------------	----------------------------------	-------------------------------	--------------------------------	---------------------------------	-------------------------------------	------------------------------------	---------------------------------------	---	--------------------------------	-------------------------------------	--------------------------	--------------------------------	---------------------------	--------------------------------------	-------------------------------------	-------------------------------------	-------------------------------	----------

PART LIST

CODE	QTY
A	1
B	1
C	1
D	1
E	1
F	1
G	1
H	1
I	2
J	2
K	1
L	1
M	1
N	1
O	1

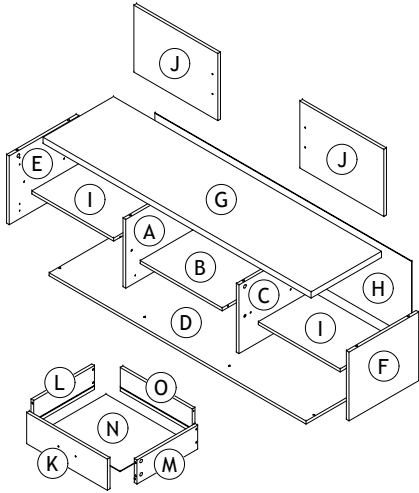

STEP 1

YOU WILL NEED :-	
I	8 PCS
II	12 PCS

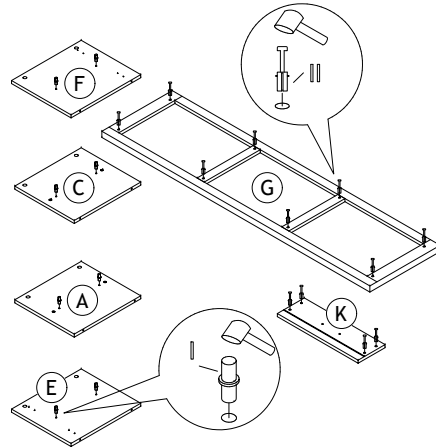

STEP 2

YOU WILL NEED :-	
XVII	1 SET
XVIII	8 PCS

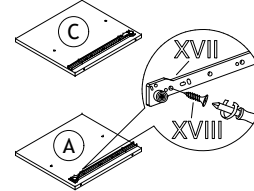

IMPORTANT NOTE :

PLEASE CHOOSE THE CORRECT SCREW HOLE BEFORE FITTING THE DRAWER RUNNER.



STEP 3

YOU WILL NEED :-	
XI	4 SETS
XII	8 PCS

PLEASE PUT ANOTHER BOARD IN ORDER TO ALIGN THE HINGES ACCORDINGLY.

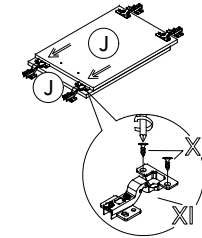

STEP 4

YOU WILL NEED :-	
V	4 PCS
IV	1 PC
VI	4 PCS
VII	4 PCS
VIII	2 PCS

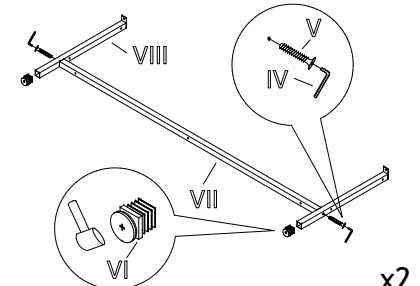

x2

MINIFIX SETUP

STEP 5

YOU WILL NEED :-	
III	12 PCS
IV	1 PC
II	8 PCS

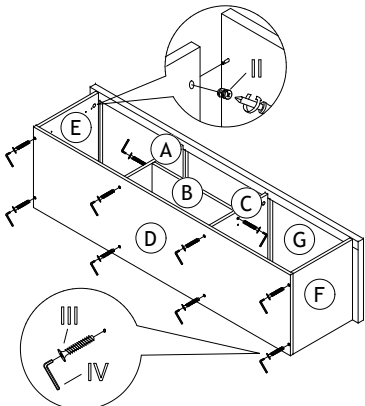

STEP 6

YOU WILL NEED :-	
XIII	36 PCS
IX	4 PCS
X	14 PCS
XIX	1 PC
XII	4 PCS

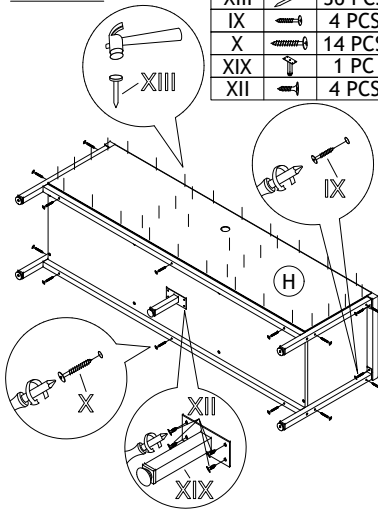

STEP 7

YOU WILL NEED :-	
XII	16 PCS
XV	2 PCS
XVI	4 PCS

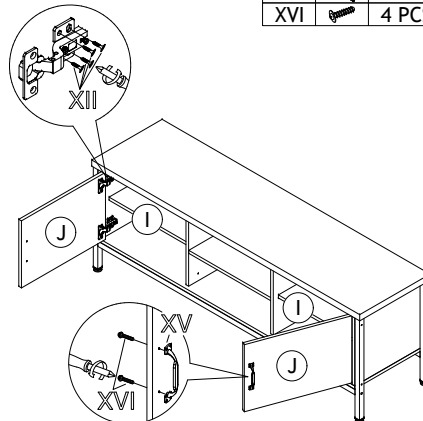

STEP 8

YOU WILL NEED :-	
II	4 PCS
XX	4 PCS
XVII	1 SET
XIV	6 PCS
XV	4 PCS
XVI	1 PC
XVI	2 PCS

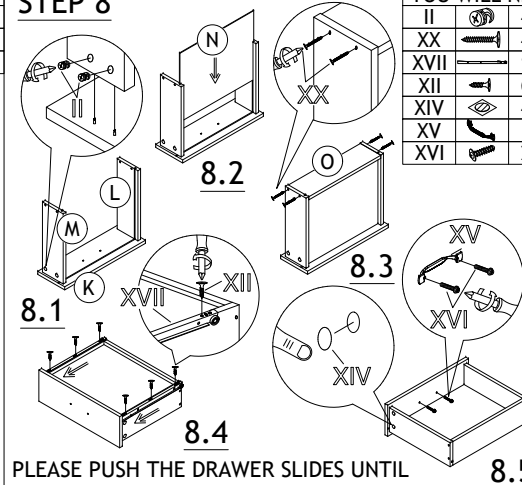

PLEASE PUSH THE DRAWER SLIDES UNTIL THE END ACCORDING TO THE ARROW'S DIRECTION SHOWN ABOVE.

COMPLETE

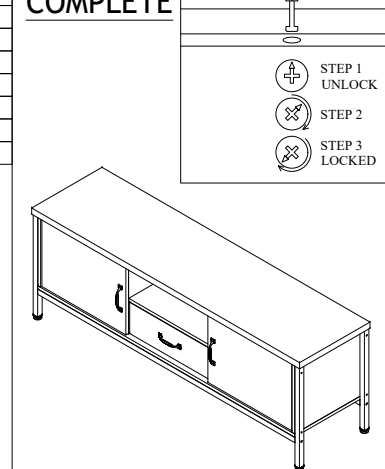

ASSEMBLY INSTRUCTIONS

DO NOT FULLY TIGHTEN ANY BOLTS BEFORE ALL PARTS ARE LOOSELY ASSEMBLED. THE PRODUCT/FITTINGS MAY BE DAMAGED IF OVERTIGHTENED. BEWARE OF CROSS THREADING SCREWS AND BOLTS DURING ASSEMBLY.

SMALL COMPONENT PARTS COULD CHOK A CHILD IF SWALLOWED. WE STRONGLY RECOMMEND THAT YOU KEEP CHILDREN AWAY FROM THE WORK AREA.

MTL15