

JULIEN BAR CHAIR

①

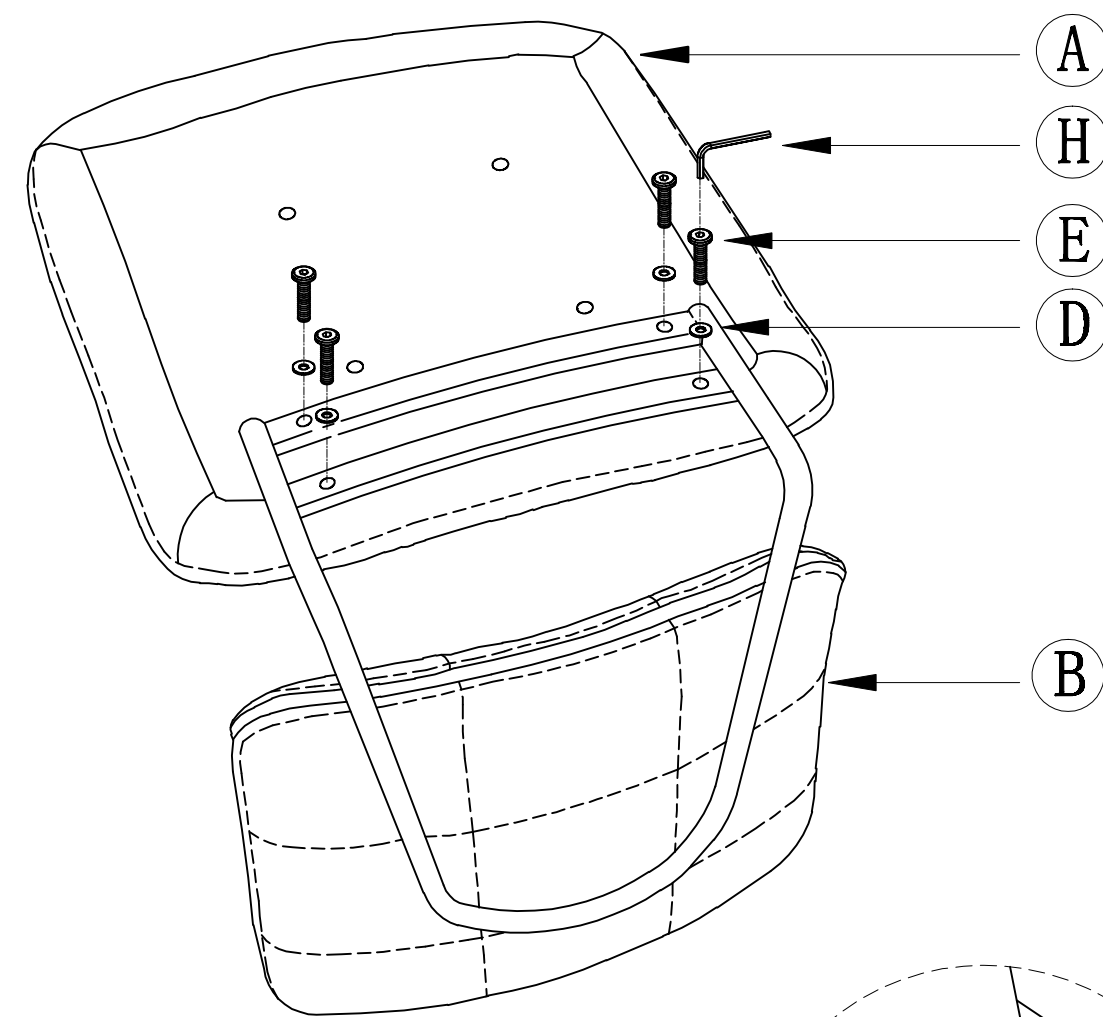

②

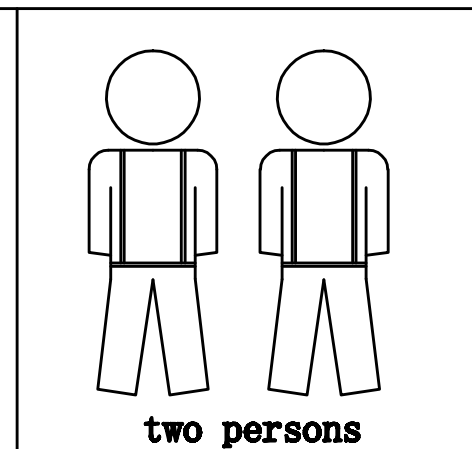
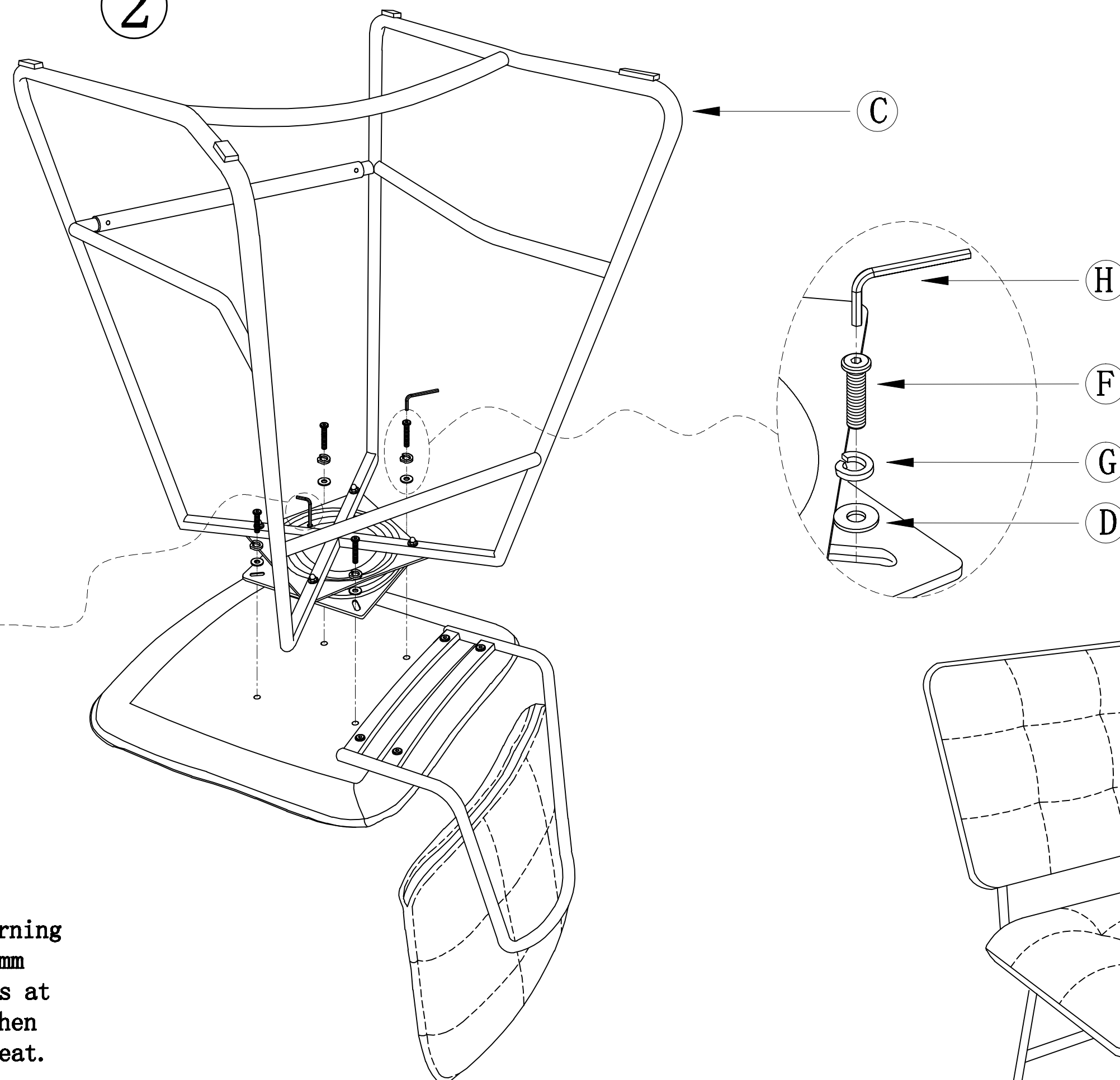

③

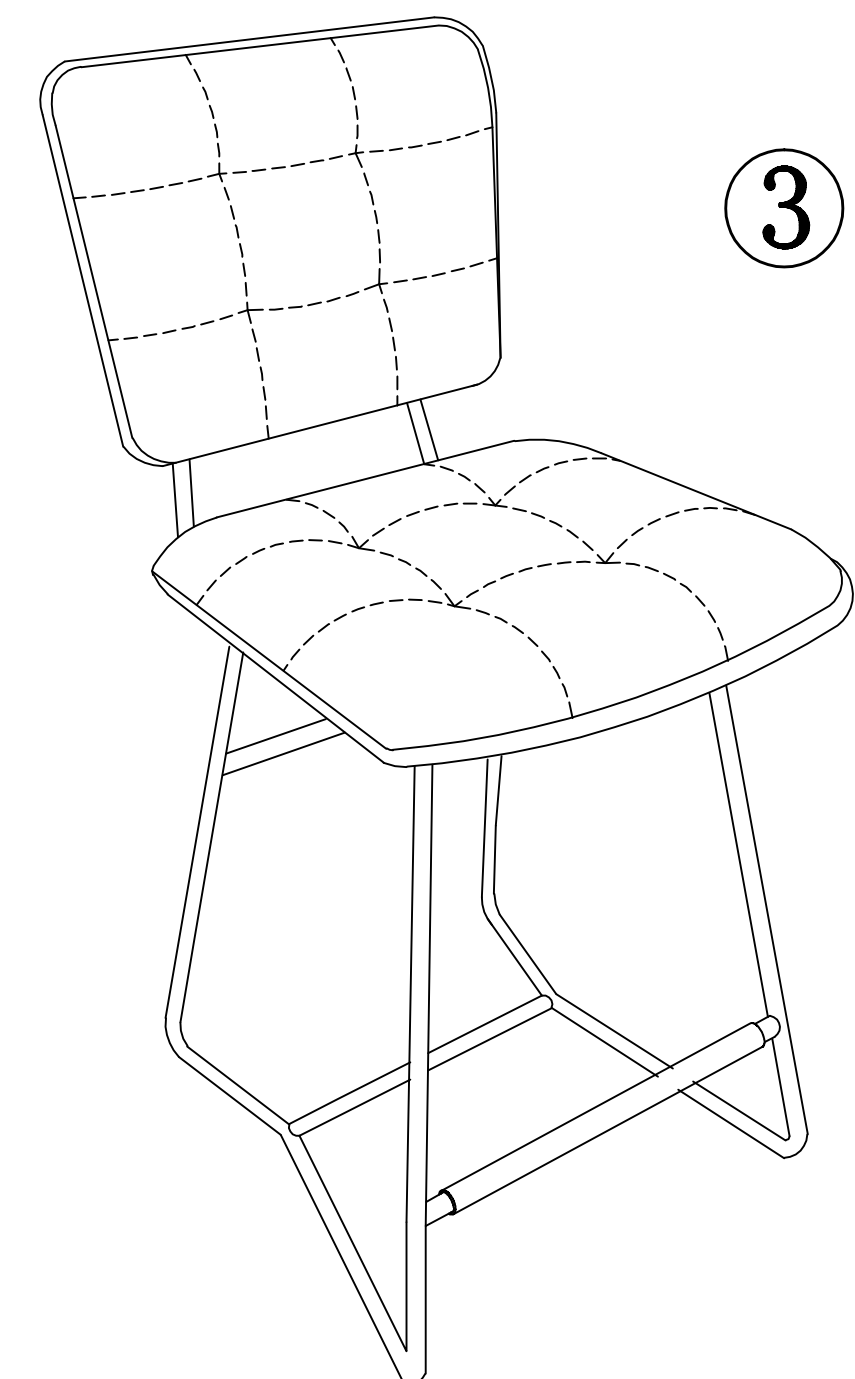

1. Take out the key, and make turning table 45 degrees and fix it by 4mm keys inside the small round holes at the other surface of the table. Then assemble the turning table and seat.

| No: | A | B | C | D | E | F | G | H |
|-----------|---|---|---|---|---|---|---|---|
| Fittings: | | | | | | | | |
| Qty: | 1 | 1 | 1 | 8 | 4 | 4 | 4 | 2 |